

- Handling system + layout
using 11PE trailers for
- inbound +
 - inventory transfer movements:

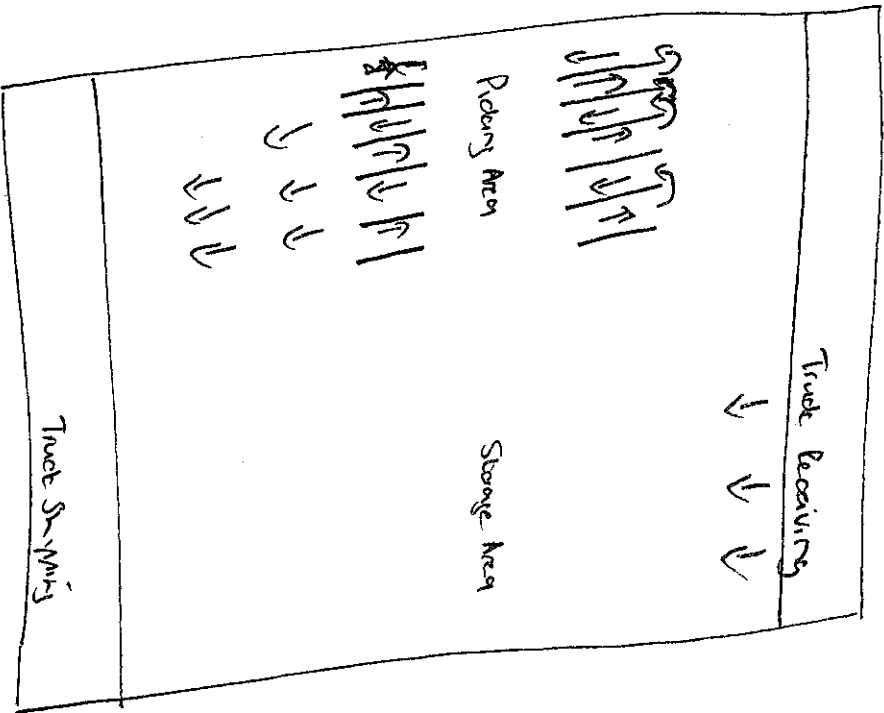

- Tow tractors + inventory collection trailers
r used for order selection
- Scenario assumes that trucks can be palletised.
- The floor plan = approximately square
+ provides the best framework for overall operating efficiency.
- Products are positioned in a specific area of the warehouse for order selection, called the selection/picking area
- The storage area = supported by a storage area
- When products are received, they are palletised + moved to the storage area.
- The selection area = replenished from storage as required
products are positioned according to
 - weight
 - bulk
 - replenishment velocity
 to minimise outband movement.

ppp

RELATIONSHIP BETWEEN MATERIAL HANDLING & THE LAYOUT OF A WAREHOUSE

Handling System Utilizing

LIFT TRUCKS

- 2 main Products inbound & for waste materials.

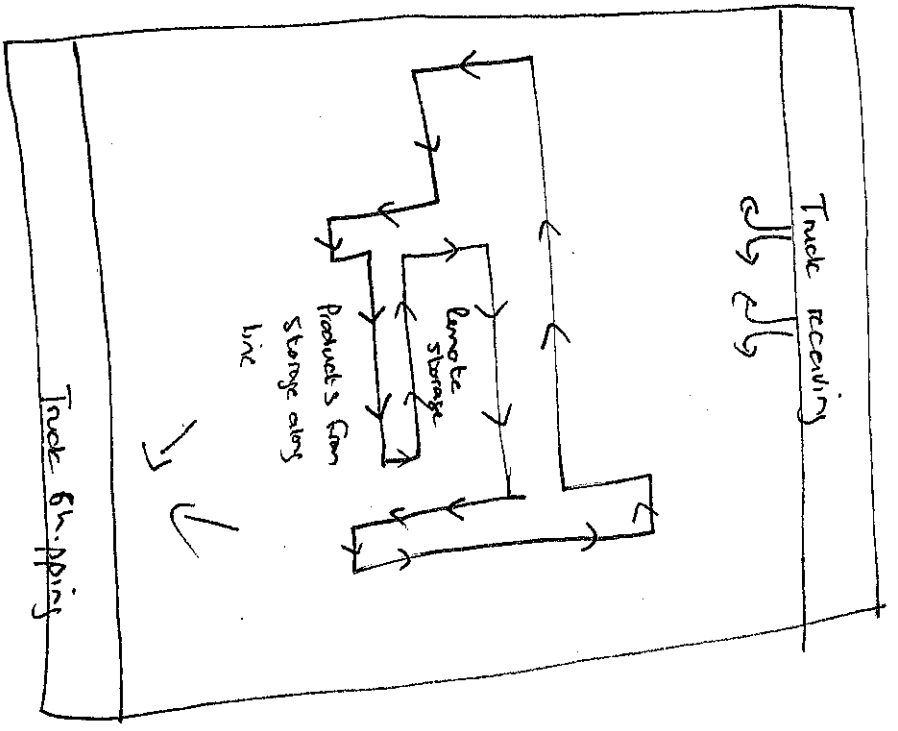

- > A continuous flow line = used for order selection
- > The floor plan = rectangular
- > Pallets are moved from receiving areas into storage positions adjacent to the haulline.
- > Orders are selected directly from storage placed on carts which are pulled around the warehouse by the haulline
- > Merchandise is stored & positioned 2 minimise internal movement.
- > The weakness of the fixed haulline = that it facilitates selection of all products @ the same speed & fixed frequency.